



VP-422

ProScale™ HDMI to Computer Graphics Video and HDTV Digital Scaler



Compatible with HDTV component video signals when used with a breakout cable such as the Kramer C-GM/3RVF.



The **VP-422** is a high-performance digital scaler for HDMI signals. It scales the input up or down to a selectable computer graphics video or HDTV output signal on a 15-pin HD connector and de-embeds the audio to an unbalanced stereo signal.

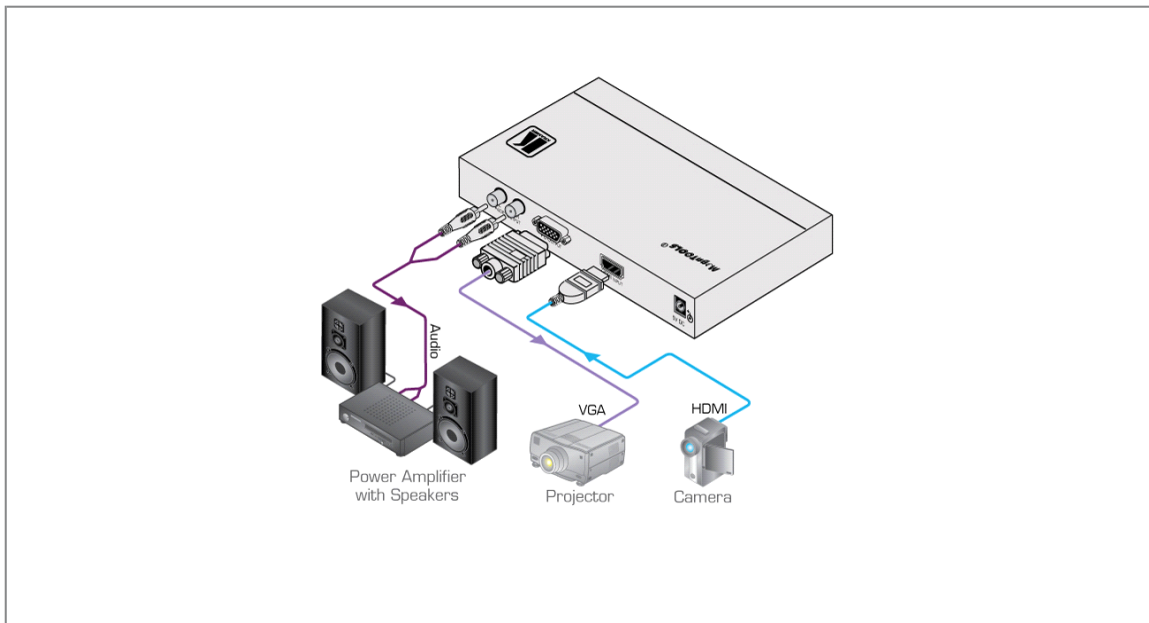



VP-422

FEATURES

- **Max. Resolution** - WUXGA & 1080p.
- **HDTV Compatible.**
- **Input** - Non-HDCP encrypted HDMI or DVI signal on an HDMI connector.
- **Outputs** - RGBHV & component video (selectable) on a 15-pin HD connector, and stereo unbalanced audio on RCA connectors.
- **Built-in ProcAmp** - Color, sharpness, brightness, contrast, etc.
- **Controls** - Front panel with On-Screen Display (OSD).
- **Compact MegaTOOLS™** - 2 units can be rack mounted side-by-side in a 1U rack space with the optional RK-T2B universal rack adapter.

TECHNICAL SPECIFICATIONS

INPUT:	1 HDMI connector HDMI version 1.2, HDCP version 1.1.
OUTPUTS:	1 VGA on a 15-pin HD connector, RGBHV/YPbPr; 1 analog stereo audio on RCA connectors.
OUTPUT RESOLUTIONS:	PC: VGA, SVGA, XGA, 1280x800, UXGA, SXGA, WXGA, SXGA+, WXGA+, WSXGA, WUXGA; HDTV: 480p, 576p, 720p @50/60Hz, 1080p @50/60Hz, 1080i @50/60Hz.
OUTPUT REFRESH RATE:	60Hz for computer graphics resolutions, 50/60Hz for HDTV resolutions.
PROCESSING DELAY:	3 frames.
CONTROLS:	Front panel buttons, ON and component output LEDs.
POWER SOURCE:	5V DC, 860mA.
DIMENSIONS:	18.8cm x 11.4cm x 2.5cm (7.4" x 4.5" x 0.98") W, D, H.
WEIGHT:	0.66kg (1.45lbs) approx.
ACCESSORIES:	Power supply.
OPTIONS:	RK-T2B 19" rack adapter.