

Model Covered:

QPT-200 ... 115 VDC variable speed*

QPT-500 ... 115 VDC variable speed*

* with proper controller

Heavy Duty (for 200 & 500 pound loads)

Electro-Mechanical Pan & Tilt



MODEL	SERIES	DESCRIPTION
7-56050-1	QPT-200	115 VDC; pan $\pm 180^\circ$, 10°/sec; tilt $\pm 90^\circ$, 3°/sec with pots, heater, 0.25° repeatability
7-60056-2	QPT-500	115 VDC; pan $\pm 180^\circ$, 10°/sec; tilt $\pm 90^\circ$, 3°/sec with pots, heater, 0.25° repeatability

Dimensions are in inches [mm]

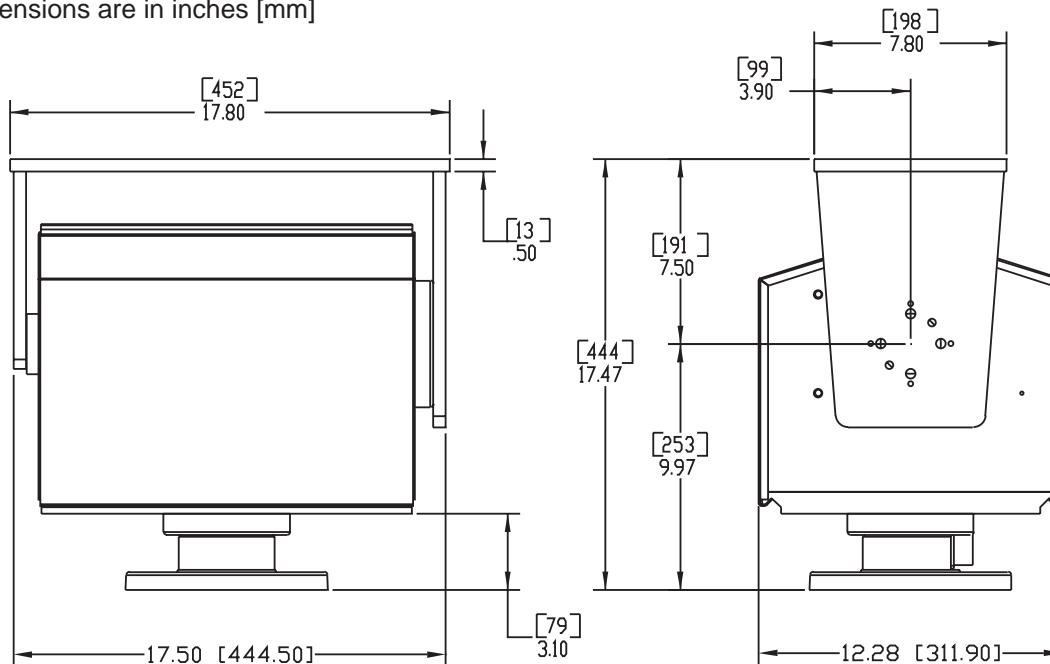

KEY FEATURES:

- Designed for Heavy Duty Operation
- 200 lbs. (91 kg) load capacity QPT-200
- 500 lbs. (227 kg) load capacity QPT-500
- 360° ($\pm 180^\circ$) pan rotation, 180° ($\pm 90^\circ$) tilt range
- All metal gearing, stainless steel external hardware
- Aluminum housing, stainless steel covers with powder coat finish
- Heater included
- Potentiometers included for position feedback

For Those Who Demand Durability!

SPECIFICATIONS OF PAN & TILT QPT-200/QPT-500

	QPT-200	QPT-500
Voltage	115VDC	115VDC
Load Capacity	200 lbs. (91 kg)	500 lbs. (227 kg)
Duty Cycle	Intermittent	Intermittent
Pan Range	360° (±180°)	360° (±180°)
Pan Speed Range (± 1°)	.4° - 10° / sec.	.4° - 10° / sec.
Pan Torque	60 foot-pounds	60 foot-pounds
Pan Motor Current	0.5 amp	0.5 amp
Tilt Range	180° (±90°)	180° (±90°)
Tilt Speed Range (± 1°)	.2° - 3° / sec.	.2° - 3° / sec.
Tilt Torque	200 foot-pounds	500 foot-pounds
Tilt Motor Current	0.5 amp	1.8 amp
Motor Type	Permanent Magnet	Permanent Magnet
Connector (mating connector included)	17 pin	17 pin
Weight	117 lbs. (53.2 kg)	122 lbs. (55.5 kg)
Dimensions	17.47"H x 17.8"W x 12.28"D (444mmH x 452mmW x 312mmD)	
Drivetrain	Steel gear & worm, ball & tapered roller bearings, steel chain	
Limit Switches	Internal, adjustable	
Backlash	Adjustable to 0	
Repeatibility	0.25°	
Material	Housing - Aluminum 6061 - T6, External Hardware & Covers - Stainless Steel	
Exterior Color/Finish	Dupont 326162A, Ford PFWS9 Powder Coated (custom colors/private labeling upon request)	
Environmental Enclosure	Gasketed & sealed to withstand water & dust penetration	
Heater	120 volt, 450 watt	
Operating Temperature	+5°F to +131°F (-15°C to +55°C) (without heater operating) -22°F to +131°F (-30°C to +55°C) (with heater operating)	

*Specifications may change without notice

TABLE TOP MOUNTING HOLE DIMENSIONS

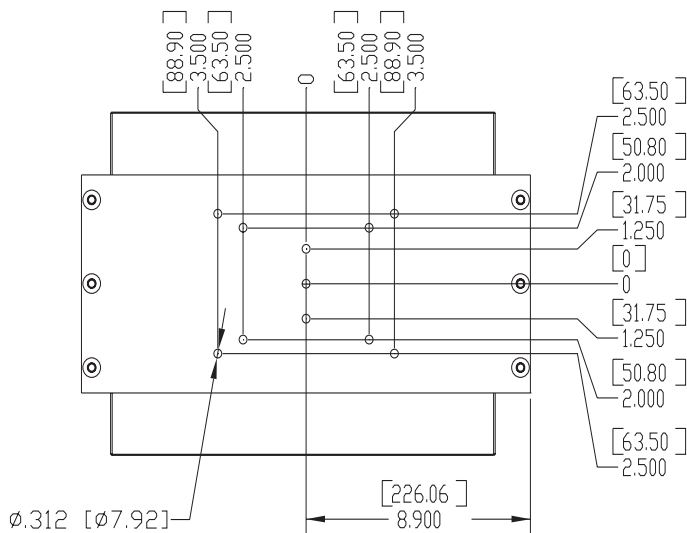

BASE MOUNTING HOLE DIMENSIONS

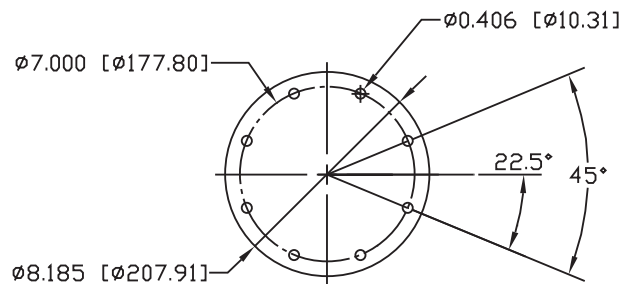

Dimensions are in inches [mm]